

SAIL-7/8BG-4-10U

Weidmüller Interface GmbH & Co. KG

Klingenbergstraße 26

D-32758 Detmold

Germany

www.weidmueller.com

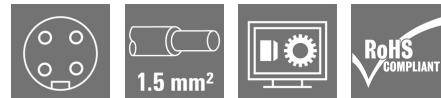

Sensor/actuator cables are used for wiring sensors and actuators and for transmitting data or power in various applications. The moulded cable offers connected and tested connection of the plug-in connector to the cable ex-works. The cables may be exposed to a wide range of conditions, such as humidity, dust, heat, cold, shock or vibration.

The 7/8" cables tend to be used for power supply applications.

Is there something you have not managed to find or you feel needs explanation? Talk to us!

General ordering data

| | |
|------------|--|
| Version | Sensor/actuator line, One end without connector, 7/8", Number of poles : 4 (3 + PE), 10 m, Female socket, straight, Shielded: No, LED: No, Sheath material: PUR, Halogen: No |
| Order No. | 1292141000 |
| Type | SAIL-7/8BG-4-10U |
| GTIN (EAN) | 4050118088021 |
| Qty. | 1 pc(s). |

Creation date March 23, 2021 2:47:21 PM CET

Catalogue status 12.03.2021 / We reserve the right to make technical changes.

SAIL-7/8BG-4-10U

Weidmüller Interface GmbH & Co. KG
 Klingenbergstraße 26
 D-32758 Detmold
 Germany

www.weidmueller.com

Technical data

Dimensions and weights

Net weight 600 g

Environmental Product Compliance

REACH SVHC Lead 7439-92-1

Technical specifications for cable

| | | | |
|--|---------------------------|--------|--|
| Bending radius, min., moving | 7.5 x cable diameter | | |
| Cable length | 10 m | | |
| Colour coding | brown, white, blue, black | | |
| Configurable cable length | No | | |
| Core cross-section | 1.5 mm ² | | |
| Halogen | No | | |
| Housing main material | PUR | | |
| Insulation | TPM | | |
| Number of poles | 4 | | |
| Number of poles | 4 (3 + PE) | | |
| Outer cladding in accordance with UL AWM style | 20234 (80 °C / 1000 V) | | |
| Outer diameter | 8.0 mm | | |
| Outside diameter | Diameter | 8 mm | |
| | Signs | ± | |
| | Tolerance | 0.2 mm | |
| Outside diameter | 8 mm ± 0.2 mm | | |
| PE function | Yes | | |
| Resistant to welding beads | No | | |
| Sheath material | PUR | | |
| Sheathing colour | black | | |
| Shielded | No | | |
| Suitable for cable carriers | No | | |
| Temperature range, moving | -20...80 °C | | |
| Temperature range, moving, max. | 80 °C | | |
| Temperature range, moving, min. | -20 °C | | |
| Temperature range, stationary | -50...80 °C | | |
| Temperature range, stationary, max. | 80 °C | | |
| Temperature range, stationary, min. | -50 °C | | |
| Torsion resistance | 0 °/m | | |

General technical data

| | | | |
|---------------------------------|-----------------------|------------------------------|-------------------------|
| Coding | none | Connection thread | 7/8" |
| Contact surface | Au (Gold) | Housing main material | PUR |
| Insulation strength | 10 ⁸ Ω | LED | No |
| Plugging cycles | ≥ 100 | Pollution severity | 3 |
| Protection degree | IP68, when screwed in | Rated current | 9 A |
| Rated voltage | 300 V | Temperature range of housing | -25...+80 °C |
| Threaded ring material jumpered | Diecast zinc No | Version | Female socket, straight |

SAIL-7/8BG-4-10U

Weidmüller Interface GmbH & Co. KG
Klingenbergstraße 26
D-32758 Detmold
Germany

www.weidmueller.com

Technical data

Classifications

| | | | |
|-------------|-------------|-------------|-------------|
| ETIM 6.0 | EC001855 | ETIM 7.0 | EC001855 |
| ECLASS 9.0 | 27-06-03-11 | ECLASS 9.1 | 27-06-03-11 |
| ECLASS 10.0 | 27-06-03-11 | ECLASS 11.0 | 27-06-03-11 |

Approvals

Approvals



| | |
|-----------------------|---------|
| ROHS | Conform |
| UL File Number Search | E307231 |

Downloads

| | |
|------------------|------------------------------|
| Engineering Data | EPLAN, WSCAD |
|------------------|------------------------------|

SAIL-7/8BG-4-10U

Weidmüller Interface GmbH & Co. KG
 Klingenbergstraße 26
 D-32758 Detmold
 Germany

www.weidmueller.com

Drawings

Dimensioned drawing

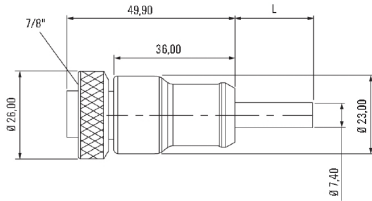

Straight socket

Pole scheme

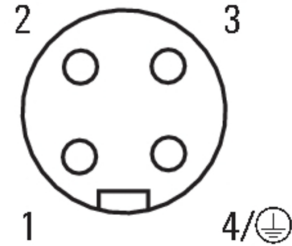

Socket

Wiring diagram

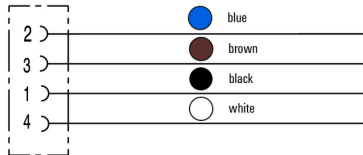

The ideal tool: Screwty[®] with torque function



Light, securely screwed-in round plug-in connectors. Screwty set DM / VPE: 1 / Order No.: 1920000000 Adapters: M12, M12 F, M8, M8 F