

HDC MHD 12 FC**Weidmüller Interface GmbH & Co. KG**

Klingenbergstraße 26

D-32758 Detmold

Germany

www.weidmueller.com

**Flexible**

The four module sizes make for individual plug solutions that save a huge amount of space. The smaller pitch translates into an optimised design too.

General ordering data

Version	Module, 12-pole, Socket connector, Module
Order No.	1428850000
Type	HDC MHD 12 FC
GTIN (EAN)	4050118233087
Qty.	1 pc(s).

Creation date March 23, 2021 10:32:51 PM CET

Catalogue status 12.03.2021 / We reserve the right to make technical changes.

HDC MHD 12 FC

Weidmüller Interface GmbH & Co. KG

Klingenbergstraße 26

D-32758 Detmold

Germany

www.weidmueller.com

Technical data

Dimensions and weights

Depth	34 mm	Depth (inches)	1.339 inch
Height	38.9 mm	Height (inches)	1.531 inch
Net weight	10.265 g	Width	14.5 mm
Width (inches)	0.571 inch		

Temperatures

Limit temperature	-40 °C ... 125 °C
-------------------	-------------------

Environmental Product Compliance

REACH SVHC	Potassium perfluorobutane sulfonate 29420-49-3
------------	--

General data

Insulation strength	$10^{12} \Omega$	Material	Polycarbonate, glass fibre reinforced
Number of poles	12	Plugging cycles	≥ 500
Pollution severity	3	Rated current (DIN EN 61984)	10 A
Rated impulse voltage (DIN EN 61984)	4 kV	Rated voltage (DIN EN 61984)	250 V
Rated voltage according to UL/CSA	600 V	Required plug-in slots	1
Series	ModuPlug	Surge voltage category	III
Type	Female	UL 94 flammability rating	V-0

PE connection data

Connection type PE	Screw connection via module frame
--------------------	-----------------------------------

Version

Conductor cross-section, max.	2.5 mm ²	Conductor cross-section, min.	0.14 mm ²
Stripping length, rated connection	8 mm	Type of connection	Crimp connection
Wire connection cross section AWG, max.	AWG 14	Wire connection cross section AWG, min.	AWG 26

Classifications

ETIM 6.0	EC002312	ETIM 7.0	EC002312
ECLASS 9.0	27-44-02-92	ECLASS 9.1	27-44-02-18
ECLASS 10.0	27-44-02-92	ECLASS 11.0	27-44-02-92

Approvals

Approvals



ROHS	Conform
UL File Number Search	E92202

HDC MHD 12 FC

Weidmüller Interface GmbH & Co. KG
Klingenbergstraße 26
D-32758 Detmold
Germany

www.weidmueller.com

Technical data**Downloads**

Approval/Certificate/Document of Conformity	Manufacturer's declaration
Engineering Data	STEP
Engineering Data	EPLAN

HDC MHD 12 FC

Weidmüller Interface GmbH & Co. KG
 Klingenbergstraße 26
 D-32758 Detmold
 Germany

Drawings

www.weidmueller.com

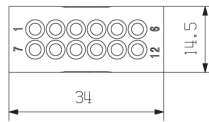
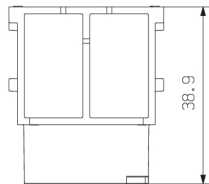

HDC-MHD 12-Module im IP65-Gehäuse,
 Leiter H05V-K0,5:

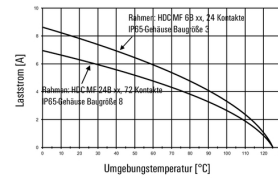

HDC-MHD 12-Module im IP65-Gehäuse,
 Leiter H07V-K2,5:

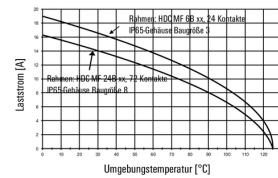

HDC-MHD 12-modules in the IP65-housing,
 Conductor H05V-K0.5:

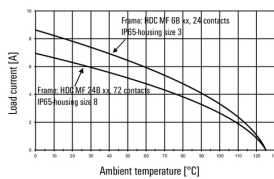

HDC-MHD 12-modules in the IP65-housing,
 Conductor H07V-K2.5:

