

**SAIL-M12GM12G-CD-0.25A****Weidmüller Interface GmbH & Co. KG**

Klingenbergstraße 26

D-32758 Detmold

Germany

www.weidmueller.com



The most reliable way of achieving connections between two I/O slaves or between the control and one I/O subscriber is by way of pre-assembled cables. The line of cables covers PROFIBUS, CANopen, DeviceNet™, EtherCAT and Ethernet.

**General ordering data**

|            |   |
|------------|---|
| Version    | Bus line, Connecting line, M12 / M12, Number of poles: 5, 0.25 m, Shielded: Yes, LED: No, Sheath material: PUR, Halogen: No |
| Order No.  | <a href="#">1964710025</a>  |
| Type       | SAIL-M12GM12G-CD-0.25A  |
| GTIN (EAN) | 4050118479232   |
| Qty.       | 1 pc(s).  |

Creation date March 26, 2021 3:48:06 PM CET

Catalogue status 12.03.2021 / We reserve the right to make technical changes.

## SAIL-M12GM12G-CD-0.25A

**Weidmüller Interface GmbH & Co. KG**

Klingenbergstraße 26

D-32758 Detmold

Germany

www.weidmueller.com

## Technical data

### Dimensions and weights

Net weight 44 g

### Environmental Product Compliance

REACH SVHC Lead 7439-92-1

### Technical specifications for cable

|  |   |        |  |
|--|---|--------|--|
| Acceleration                                   | 5 m/s <sup>2</sup>                                  |        |  |
| Bending cycles                                 | 3 Mio   |        |  |
| Bending radius, min., moving                   | 10 x cable diameter                                 |        |  |
| Bending radius, min., stationary               | 5 x cable diameter                                  |        |  |
| Cable length                                   | 0.25 m  |        |  |
| Colour coding                                  | white, blue, red, black                             |        |  |
| Configurable cable length                      | No  |        |  |
| Halogen  | No  |        |  |
| Housing main material                          | PUR   |        |  |
| Hybrid cable                                   | No  |        |  |
| Insulation                                     | TPE   |        |  |
| Irradiation crosslinked                        | No  |        |  |
| Number of poles                                | 5   |        |  |
| Number of poles                                | 5   |        |  |
| Outer cladding in accordance with UL AWM style | 20236 (80 °C / 30 V)                                |        |  |
| Outer diameter                                 | 7.0 ± 0.3 mm  |        |  |
| Outside diameter                               | 7 mm ± 0.3 mm                                       |        |  |
| Outside diameter                               | Diameter  | 7 mm   |  |
|  | Signs   | ±      |  |
|  | Tolerance   | 0.3 mm |  |
| Resistant to welding beads                     | No  |        |  |
| Sheath material                                | PUR   |        |  |
| Sheathing colour                               | black   |        |  |
| Shielded                                       | Yes   |        |  |
| Speed  | 180 m/min   |        |  |
| Suitable for cable carriers                    | Yes   |        |  |
| Temperature range, moving                      | -10...80 °C   |        |  |
| Temperature range, moving, max.                | 80 °C   |        |  |
| Temperature range, moving, min.                | -10 °C  |        |  |
| Temperature range, stationary                  | -40...80 °C   |        |  |
| Temperature range, stationary, max.            | 80 °C   |        |  |
| Temperature range, stationary, min.            | -40 °C  |        |  |
| Wire cross section                             | 2 x 0.34 mm <sup>2</sup> + 2 x 0.22 mm <sup>2</sup> |        |  |

### General technical data

|                        |                      |                              |                   |
|------------------------|----------------------|------------------------------|-------------------|
| Coding                 | A                    | Connection thread            | M12 / M12         |
| Contact surface        | Gold-plated          | Housing main material        | PUR               |
| Insulation strength    | 10 <sup>8</sup> Ω    | LED                          | No                |
| Plugging cycles        | ≥ 100                | Pollution severity           | 3                 |
| Protection degree      | IP67                 | Rated current                | 4 A               |
| Rated voltage          | 125 V                | Temperature range of housing | -25...+80 °C      |
| Threaded ring material | Brass, nickel-plated | Tightening torque            | M12: 0.8 - 1.2 Nm |
| jumpered               | No                   |                              |                   |

Creation date March 26, 2021 3:48:06 PM CET

Catalogue status 12.03.2021 / We reserve the right to make technical changes.

**SAIL-M12GM12G-CD-0.25A****Weidmüller Interface GmbH & Co. KG**

Klingenbergstraße 26

D-32758 Detmold

Germany

www.weidmueller.com

**Technical data****Electrical properties**

|                     |                   |               |       |
|---------------------|-------------------|---------------|-------|
| Insulation strength | 10 <sup>8</sup> Ω | Rated voltage | 125 V |
|---------------------|-------------------|---------------|-------|

**Cable structure**

|                  |                         |            |     |
|------------------|-------------------------|------------|-----|
| Colour coding    | white, blue, red, black | Insulation | TPE |
| Sheathing colour | black                   |            |     |

**Electrical properties of cable**

|                     |                   |               |     |
|---------------------|-------------------|---------------|-----|
| Insulation strength | 10 <sup>8</sup> Ω | Rated current | 4 A |
| Speed               | 180 m/min         |               |     |

**Mechanical and material properties of cable**

|              |                    |                |           |
|--------------|--------------------|----------------|-----------|
| Acceleration | 5 m/s <sup>2</sup> | Bending cycles | 3 Mio     |
| Halogen      | No                 | Speed          | 180 m/min |

**Plug, right**

|                 |             |                       |     |
|-----------------|-------------|-----------------------|-----|
| Contact surface | Gold-plated | Housing main material | PUR |
| Plugging cycles | ≥ 100       |                       |     |

**Classifications**

|             |             |             |             |
|-------------|-------------|-------------|-------------|
| ETIM 6.0    | EC001855    | ETIM 7.0    | EC001855    |
| ECLASS 9.0  | 27-06-03-11 | ECLASS 9.1  | 27-06-03-11 |
| ECLASS 10.0 | 27-06-03-11 | ECLASS 11.0 | 27-06-03-11 |

**Approvals**

|      |         |
|------|---------|
| ROHS | Conform |
|------|---------|

**Downloads**

|                  |                              |
|------------------|------------------------------|
| Engineering Data | <a href="#">EPLAN, WSCAD</a> |
|------------------|------------------------------|

**SAIL-M12GM12G-CD-0.25A**

**Weidmüller Interface GmbH & Co. KG**  
 Klingenbergstraße 26  
 D-32758 Detmold  
 Germany

www.weidmueller.com

**Drawings**

**Dimensioned drawing**

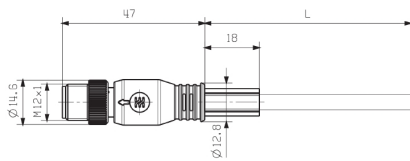

Male, straight

**Pole scheme**

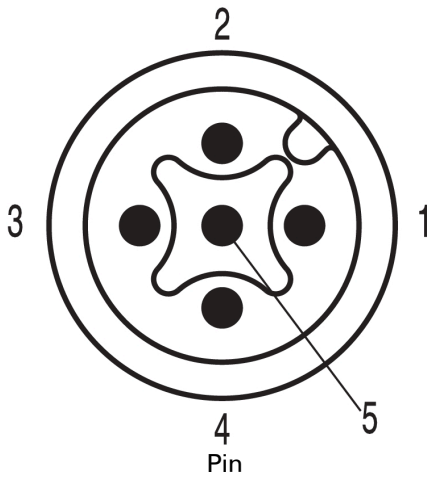

**Dimensioned drawing**

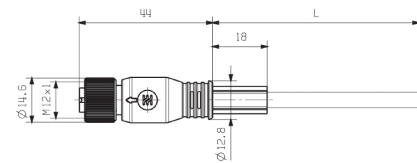

Straight socket

**Pole scheme**

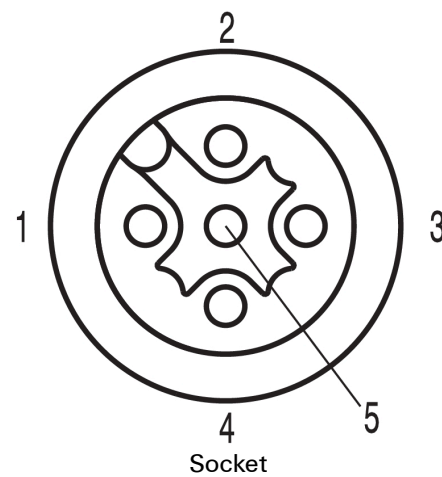

**Wiring diagram**

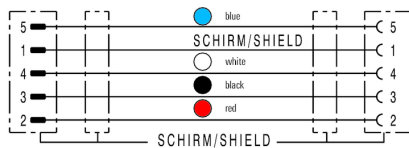

**The ideal tool: Screwty® with torque function**



Light, securely screwed-in round plug-in connectors. Screwty set DM / VPE: 1 / Order No.: 1920000000 Adapters: M12, M12 F, M8, M8 F